

P810027 5.5IN Low Profile Flush Mount

 Wet location listed **PROGRESS LED** 

Description:

The P810027 delivers a solution for residential and light commercial applications. The slim, low-profile design can be mounted onto junction boxes as shallow as 1/2". The P810027 is listed for Wet Locations and is suitable for covered ceiling and wall mounting. The P810027 is a cost effective solution for fire rated applications when using a fire rated junction box. The P810027 is capable of flicker free dimming down to 10% with many Electronic Low Voltage (ELV) and Forward Phase (TRIAC) dimmers.

Specifications:

- White (-028) (Painted)
- Die-cast aluminum construction with a powder coat paint finish
- Diffused polycarbonate lens controls direct glare from the LEDs
- Simple snap in installation for J-Box with 1/2" minimum depth
- Lumen output and distribution comparable to a 65W incandescent lamp
- Dimmable to 10% brightness with many Electronic Low Voltage (ELV) & Forward Phase (TRIAC) dimmers
- CSA Listed for Wet Location applications
- Energy Star listed
- Meets California Title 24 - JA8 - 2016
- Fixture installs to 4" Octagon metallic junction boxes, 4" Round non-metallic junction boxes and 4" x 1/2" round ceiling pan junction box.
- Mounting strap for outlet box included

Performance:

Input Power	11.5w
Input Voltage	120 V
Input Frequency	60 Hz
Lumens/LPW	782/68 (LM-79)
CCT	3000 K
CRI	90 CRI
Life (hours)	50,000 (L70/TM-21)
EMI/RFI	FCC Title 47, Part 15 Class B
Min. Start Temp	-25 °C
Max. Operating Temp	30°C
Warranty	5 year warranty
Labels	cCSAus Wet location listed ENERGY STAR® qualified Meets California Title 24 - JA8 - 2016

P810027-028-30

Images:

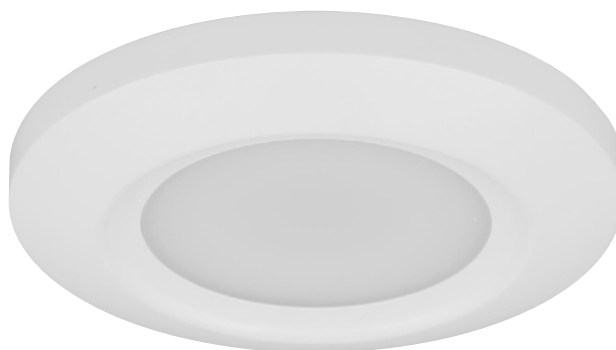

Dimensions:

- (A) Height: 1.22"
- (B) Diameter: 5.5"
- (C) Light Emitting Surface (LES): 3.125"

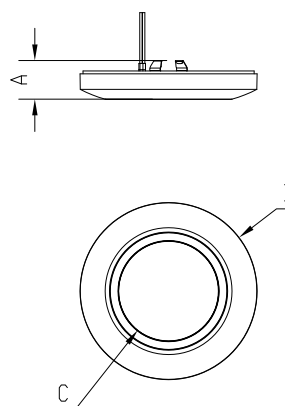

Photometrics:

P810027-028-30

ELECTRICAL DATA	P810027-028-30
Input Voltage	120 V
Input Frequency	60 Hz
Input Current	0.104 A
Input Power	11.5 W
Power Factor	0.921
THD	>20%
EMI Filtering	FCC Title 47, Part 15 Class B
Operating Temperature	-25 °C to 30°C
Dimming	Yes*
Over-voltage, over-current, short-circuit protected	
*See Dimming Notes for more information	

P810027-028-30

LED Light Engine: 3000 K 90 CRI CRI
System Wattage: 11.5
Fixture delivered lumens: 782
Fixture Efficacy: 68
Spacing Criteria: 1.2

CANDELA DISTRIBUTION

DEG	CANDELA	LUMENS
0	307	
5	305	29
15	291	82
25	264	122
35	227	142
45	182	141
55	137	122
65	90	89
75	44	47
85	4	7
90	0	

ZONAL LUMEN SUMMARY

ZONE	LUMENS	%FIXT
0-30	233	29.8
0-40	375	47.9
0-60	638	81.6
0-90	782	100.0
90-180	0	0.0
0-180	782	100.0

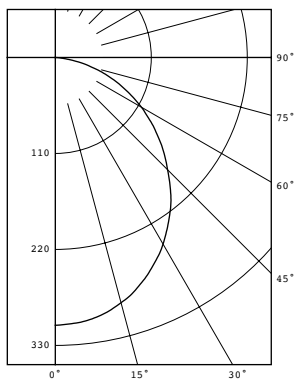

P810027-028-30

Dimming Notes:

P810027 is designed to be compatible with many Electronic Low Voltage (ELV) and Forward Phase (TRIAC) dimmers.

The following is a partial list of known compatible dimmer controls.

Dimming Controls

Lutron	NTEVL-300
Lutron	DVELV-300P
Lutron	DVCL-253P
Lutron	Caseta Wireless
Idevices	IDEV009
Leviton	6672
Leviton	6674
Lutron	AYCL-153P
Lutron	TGCL-153-PH-WH
Eaton/Cooper	DAL06P
Lutron	AYLV-600P
Lutron	MAELV-601
Leviton	AWSMT-EAW
Lutron	N-600

Dimming capabilities will vary depending on the dimmer control, load, and circuit installation. Always refer to dimmer manufacturer instructions or a controls specialist for specific requirements.

Dimmer control brand names where identified above are trade names or registered trademarks of each respective company.